

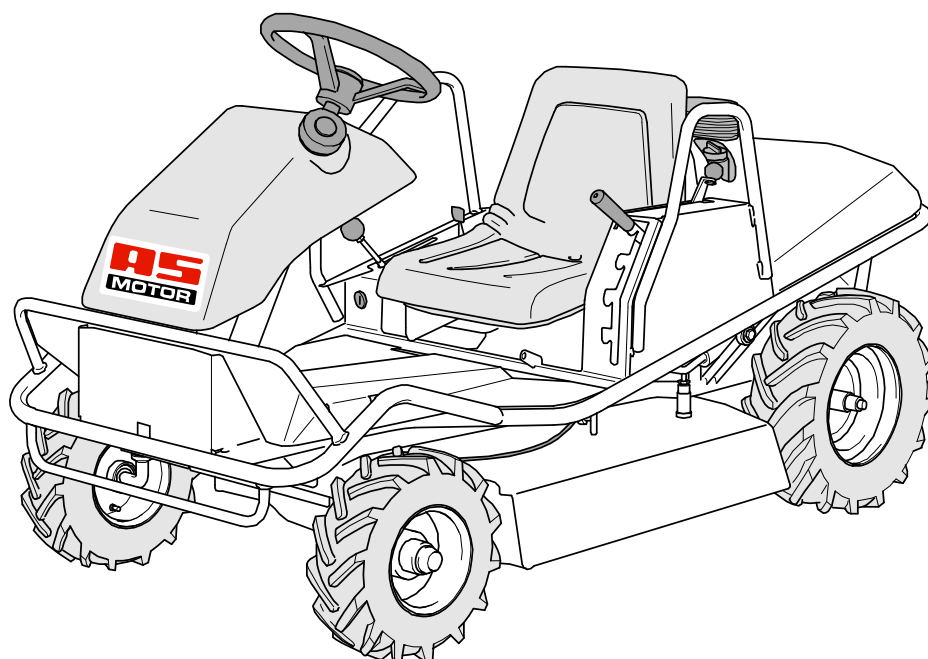

# Operating Instructions

Ride-on Allmäher®

AS 800 FreeRider



From serial number:

016010020001

Issued:

04 July 2011, V13.0

EN-Translation of the Original Operating Instructions

## Preface

Please fill in all data referring to your device. When ordering spare parts, provide your dealer with the device and engine number.

Serial number:

Engine number:

Date of purchase:

Address of dealer:

### Dear customer:

Congratulations on your purchase. You have acquired a reliable quality product by “AS-Motor Germany”.

This product has been manufactured according to modern manufacturing methods and comprehensive quality assurance measures. Only when you are satisfied with your device, we have attained our goal.

Read these operating instructions carefully and attentively so that your device operates smoothly and you and others are safe from any hazards. If you have questions concerning your device, please contact your dealer or call our customer service (telephone +49/(0)7973/9123-0). For international AS partners, please see: [www.as-motor.de/worldwide](http://www.as-motor.de/worldwide).

“AS-Motor Germany” wishes you much joy with your new device.

## Intended use

The device is intended for cutting and mulching grass or similar vegetation in well maintained areas that must be mowed at least once a year.

Only use attachments and cutting tools authorised by “AS-Motor Germany”.

Any use exceeding this purpose is inadmissible. The manufacturer is not responsible for any damage resulting from this. Observe the required maintenance and repair measures.

The user of the device is responsible for accidents or damage to other persons or their property!

The device **must not** be used:

- To cut hard objects, rocks, rubble, or pieces of wood.
- To trim bushes, hedges, and shrubbery.
- To cut vegetation on building roofs.
- To clean (vacuum) footpaths.
- As shredder for shredding tree and hedge cuttings.
- As drive unit for work tools and any type of tool sets that are not authorised by “AS-Motor Germany”.

The device is not licensed for driving on public roads.

# Contents

<b>Preface</b> .....	<b>2</b>	Engaging the blade .....	16
<b>Intended use</b> .....	<b>2</b>	<b>Driving</b> .....	<b>17</b>
<b>Explanation of the symbols</b> .....	<b>4</b>	Braking .....	17
Symbols in the instructions.....	4	Driving .....	17
Symbols on the device .....	4	Differential lock.....	17
<b>Safety instructions</b> .....	<b>6</b>	<b>Switching off and parking</b> .....	<b>17</b>
Get informed!.....	6	<b>Maintenance and cleaning</b> .....	<b>18</b>
User restrictions and hours of operation ...	6	Preparations .....	20
Safe handling of fuel.....	6	Cleaning the device.....	20
Check the device prior to use .....	7	General inspection .....	20
Use caution during operation .....	7	Checking the parking brake.....	20
Prior to mowing.....	7	Checking the foot brake .....	20
Use caution when mowing .....	7	Grease lubrication .....	21
Caution when using accessories .....	9	Chain lubrication.....	21
When work is completed .....	9	Checking the blade.....	21
Use caution during maintenance and repair	9	Maintaining the engine .....	22
<b>Device description</b> .....	<b>10</b>	Checking the engine oil level .....	22
<b>Control elements</b> .....	<b>11</b>	Checking the spark plugs .....	22
Front area .....	11	Cleaning the air filter .....	22
Control lever at seat .....	11	Checking and charging the battery .....	23
Drive/idle mode.....	13	Hydrostat transmission.....	23
<b>Transport</b> .....	<b>13</b>	<b>Storage</b> .....	<b>23</b>
Transport on pallets.....	13	Storing the device.....	23
Transport of ready-to-use device .....	13	Longer storage .....	24
<b>Assembly</b> .....	<b>14</b>	Restarting .....	24
Scope of delivery .....	14	<b>Spare parts</b> .....	<b>24</b>
Unpacking.....	14	<b>Wear parts</b> .....	<b>24</b>
Mounting.....	14	<b>Accessories</b> .....	<b>24</b>
<b>Information on mowing</b> .....	<b>15</b>	<b>Disposal</b> .....	<b>25</b>
<b>Prior to starting</b> .....	<b>15</b>	<b>Warranty</b> .....	<b>25</b>
Checking the oil level .....	15	<b>Troubleshooting</b> .....	<b>25</b>
Fuel.....	15	<b>Technical data</b> .....	<b>29</b>
Tanking up.....	15	<b>Declaration of conformity</b> .....	<b>31</b>
Adjusting the seating position.....	15		
<b>Starting</b> .....	<b>16</b>		
Safety switches.....	16		
Starting the engine .....	16		

## Explanation of the symbols

### Symbols in the instructions

In these operating instructions, the following symbols are used to denote special dangers.



Warning.  
These symbols denote special dangers.



Prohibition sign.  
These symbols denote inadmissible procedures.



Directive sign.  
These symbols denote required protective measures.

### Symbols on the device

The following symbols are placed on the device to inform you must be careful and attentive when using the device:

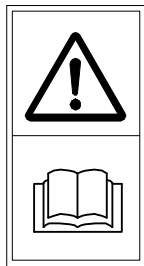

Working with the device requires extreme cautiousness. Read the operating instructions before you use the device.



Risk of injury!  
Make sure that no one is within the danger zone of the device. Objects may be ejected. The danger zone extends for at least 50 metres.

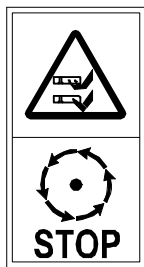

The quickly rotating blade can cause life threatening injuries or immense property damage! Be especially careful to keep your hands and feet away from the blade when the device is put into operation.

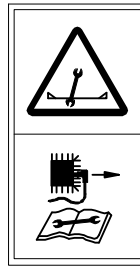

Prior to any repair and maintenance work, pull off the spark plug connector.



Risk of tipping!  
When positioned sideways to the slope, the device is stable up to 17° (in accordance with the standard measuring method ).

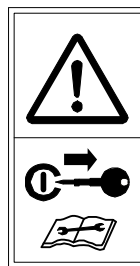

Prior to any repair and maintenance work, remove the ignition key.



Clean the ventilation grid!  
The cooling air of the motor is sucked in through the ventilation grid of the engine cover. Always keep the entire surface open and free!



Noise is causing health problems. Use personal ear protection to avoid hearing damage.

## Type plate

The type plate on the device provides you with information on the device type and the technical data.

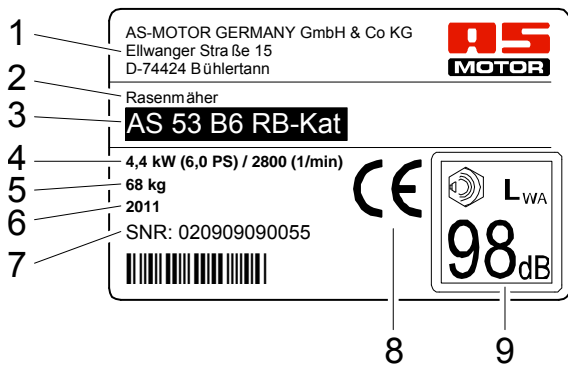

- 1 Name and address of the manufacturer
- 2 Device designation
- 3 Type designation
- 4 Rated power output in kW / engine speed
- 5 Weight
- 6 Year of manufacture
- 7 Serial number
- 8 CE marking
- 9 Sound level L<sub>WA</sub>

## Safety instructions

### Get informed!

For your safety, read these operating instructions with care. Familiarize yourself with the control elements and the proper use of the device. Share these operating instructions with other users of the device.

Before you use the device for the first time, let the dealer instruct you regarding safe use.

Practise operating the mower first in a wide, open, and flat terrain without the blade drive.

### User restrictions and hours of operation

Never give your children or other persons who are not familiar with the operation instructions permission to use the device. Persons under 18 years old may operate the device only under supervision. Local regulations will determine the minimum age of the user and the hours of operation.

Unsuitable for the operation of the device are persons

- Who are under the influence of alcohol, drugs, or medicine that slows down reaction time.
- With physical and mental impairments.



People fitted with pace makers are not allowed to touch any current carrying parts of the ignition system.

## Safe handling of fuel



### Danger!

Fuel is toxic and highly inflammable.



Danger of fire and explosion!

Keep the fuel away from ignition sources and do not smoke while handling the device.

Do not inhale fuel vapours; they are dangerous to your health.



Use gloves and avoid skin contact with the fuel.

Fuel up outdoors only when the engine is cool and not running. Use a filler or funnel.

Do not spill any fuel and do not let the fuel get into the canalisation or ground water.

If you spilled fuel, do not start the device until the fuel vapours have evaporated (wipe dry). Move the device away from the area where the fuel was spilled.

Always close the tank cap securely and do not open it while the engine is running or the device is still hot.

Drain the fuel tank only when outdoors. Use a suitable container or run the tank empty.

Keep the fuel away from children and store it in a suitable container in a dark, cool, and dry location.

Never park the device with fuel in the tank inside a building where fuel vapours could come in contact with open fire or sparks.

Immediately replace a damaged fuel tank or tank cap (authorised dealership).

### First aid

When swallowing fuel or inhaling fuel vapours, do not force vomiting and immediately consult a doctor.

In case of skin contact, immediately wash with water and soap. Change your soiled clothing as soon as you can.

## Measures in case of a fire

In case of a fire, use foam, dry powder extinguisher, or carbon dioxide (CO<sub>2</sub>). Never douse with water!

## Check the device prior to use

---

Prior to use, check by visual inspection blade, protection skirt, ejection rubber, drive and fastening parts for proper condition and firm seating.

Never use the device if covers, impact protection, ejection rubber, or protective skirt are defective or not installed

Do not remove, change or override any safety devices or control elements.

Observe the maintenance instructions and replace damaged or worn parts immediately.

Check the blade brake for proper function by switching off the blade clutch. The blade must come to a standstill from full speed within less than 5 seconds.

Check the parking brake for proper function (see Maintenance).

## Use caution during operation

---

Do not start the engine:

- if fuel was spilled.
- in closed or poorly ventilated rooms (danger of poisoning!).
- if there are other persons nearby.

After every stop and before you shut down the engine, actuate the parking brake. This prevents the device from accidentally rolling away.

Do not touch the exhaust, the engine, and the gearbox. They become very hot during operation and you can get burned. Resulting unintentional movements constitute an additional injury hazard.

Switch off the blade and wait until the blade comes to a standstill,

- when you drive on surfaces other than grass.

Switch off the engine and wait until the blade comes to a standstill and remove the ignition key

- before you transport the device.
- if you step away from the device, even for just a short time.
- before you clean or check the device or before you carry out work on the device.
- before you unblock or unclog the discharge area.

## Prior to mowing

---

### Personal protective measures



While mowing, always wear sturdy footwear with good grip, long trousers, and gloves. Do not mow in open sandals or bare feet.



Noise is causing health problems. Use personal ear protection to avoid hearing damage. Wear safety glasses and headgear.

### Preparing the mowing area

Prior to mowing, carefully check the perimeter of the lawn. Remove rocks, pieces of wood, bones, wires, and other objects that could be picked up and thrown out by the device.

## Use caution when mowing

---

### Risk of injury

Always stay within hearing range to other persons who can assist you in case of an emergency.



### **Danger!**

Risk of injury caused by thrown out objects.

Never mow while persons, children, pets, or property are in the vicinity.



The danger zone extends for at least 50 metres.

The area in front of and to the right of the device is especially dangerous.

Keep your hands and feet away from rotating parts.

Mow only in daylight or good artificial light.

Do not transport any person on the device.

Be extremely cautious when moving in reverse.

Pay attention to traffic when working close to roads.

When using the device over a longer period of time, vibrations can cause disturbances in the blood supply of the hands. A generally accepted usage time cannot be determined. Use gloves.

Take breaks on time.

Have an authorised service centre check the device immediately

- if the blade hit an object.
- if the device starts to vibrate unusually severely.

### **Caution when mowing slopes**



### **Danger!**

If the engine shuts down while you are mowing, the device can roll away.

Immediately actuate the parking brake to prevent the device from rolling away.

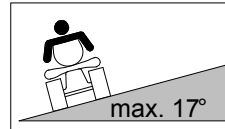

When mowing slopes, there is a risk of slipping and tilting!

- Do not mow excessively steep slopes. For safety reasons, use the device only on less than 17° slopes.
- Use a clinometer if you are not familiar with the slope (see accessories).
- Always mow up- and downwards, never in horizontal directions.
- Always move upwards first. If you are unsuccessful at moving upwards first, you must not mow the slope. Never move downwards if you were not successful at moving upwards.
- Be extremely careful when changing the direction.
- Do not turn on a slope.
- Only mow when you are familiar with the terrain and the terrain is clear of obstacles.
- Pay attention to bumps, holes, and other visible hazards.
- Do not mow close to danger zones (e.g. walls, steep declines, etc.).
- Prior to entering the slope, always actuate the differential lock. Move on slopes only when the differential lock is actuated.
- Always keep the speed low when moving on slopes.
- Do not start abruptly and do not brake abruptly.
- Hold the steering wheel tightly so that the device does not swerve.

Only park the device on flat surfaces.

Drive has good braking efficiency which can only provide sufficient grip on a non-slip surface!

If the mower starts to slide, you can regain control by actuating the brake. Uncontrolled handling is due to:

- poor tire grip.
- speeding.



- abrupt braking.
- an inappropriate task for the device.
- poor knowledge of the area.
- slope angles that are too steep.

### **Risk of tilting**

If the wheels facing uphill encounter obstacles such as roots, branches, rocks, bumps, etc., the mower can tilt or slide.

### **Risk of slipping**

When the ground is wet or loose, use extreme caution to prevent the mower from slipping. Use extreme caution when moving downhill. On cut plant material, no matter if wet or dry, the risk of slipping is high.

### **Mowing surfaces with fire hazard**

- Carry a sufficient amount of suitable extinguishing agent.
- If side inclination is too great, fuel may leak from the carburetor or the tank. This poses a fire hazard!
- Observe the mowed surface also after moving is completed to ensure that no fire will start.

To avoid risk of fire, keep the following components free of dirt, grass, hay, leaking oil, grease, etc:

- Engine
- Silencer (manifold, guard, clearances)
- Battery
- Area around the fuel tank

### **Caution when using accessories**

Be careful when pulling loads:

- Only use tow-bars authorized by “AS-Motor Germany”.
- Observe the maximum load carrying capacity (Technical data).
- Observe the safety instructions in the operating instructions of the tow-bar.
- Only transport loads that you can handle safely.
- Only drive on slopes up to 10°.

- Do not take tight corners.
- Be extremely cautious when moving in reverse.

### **When work is completed**

After each mowing, close the fuel valve.

Prior to leaving the device, wait until the blade comes to a standstill and remove the ignition key.

After switching it off, let the device cool down for at least 20 minutes before you store it in a dry, closed, sufficiently ventilated room.

Never store the device when there is fuel in the tank inside a building where fuel vapours might come into contact with open fire or sparks.

### **Use caution during maintenance and repair**

Only carry out maintenance work as described in these operating instructions. Have an authorised service centre carry out all other work.

Prior to starting any maintenance work, wait until the engine comes to a standstill and pull off the spark plug connector.

We explicitly point out that, in accordance with the Product Liability Act, we are not liable for damages that were caused by our devices if

- worn or damaged parts were not repaired or replaced on time
- these damages were caused by improper repair.
- when changing a part, our original parts or parts authorised by use were not used.
- the repair work was not carried out by an authorised service station.

The same applies for spare parts and accessories.

## Device description

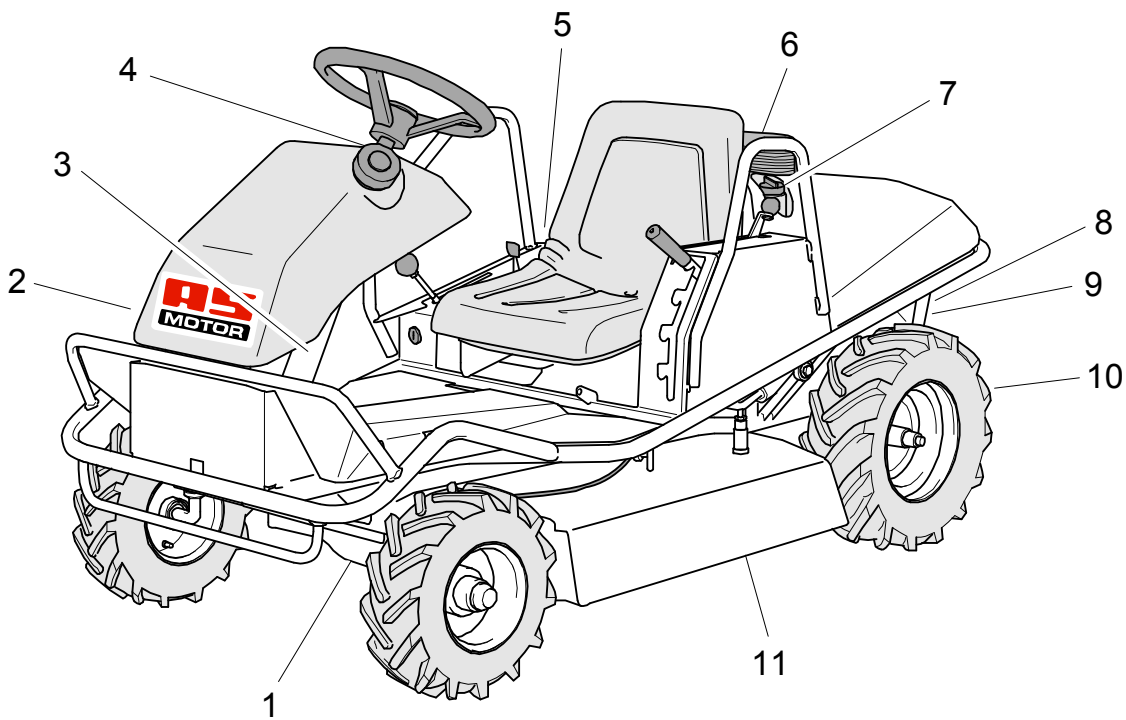

- 1 Protection skirt
- 2 Fuel valve
- 3 Type plate
- 4 Tank cap
- 5 Fuses circuit protection
- 6 Ventilation grid
- 7 Engine oil filler neck
- 8 Gearbox fan
- 9 Unlocking device drive
- 10 Ejection rubber
- 11 Side plates impact protection

# Control elements

## Front area

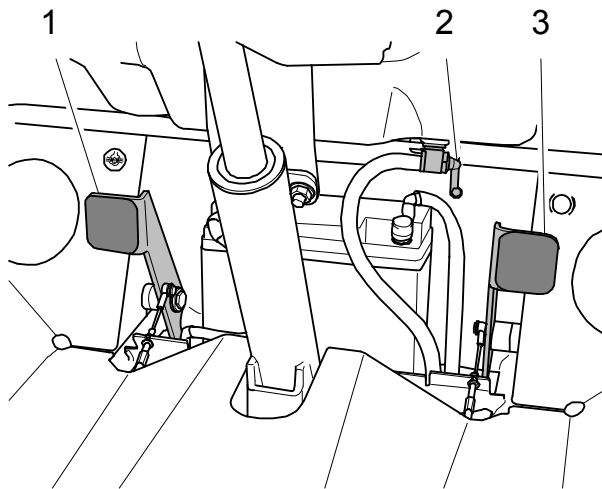

### Differential lock (1)

With the left foot pedal, actuate the differential lock.

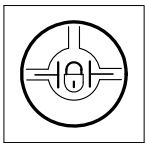

Pedal is actuated:  
Differential lock is on

Pedal in top position:  
Differential lock is off

### Fuel valve (2)

The fuel valve is located at the bottom right front of the tank.

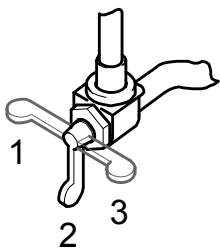

1: Reserve (R)

2: Open

3: Closed (C)

### Foot brake/parking brake (3)

By stepping on the right foot pedal, the parking brake is actuated. Use the actuation via foot pedal only in exceptional circumstances because the mower stops abruptly.

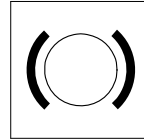

#### Braking:

Release the drive lever and press down the right foot pedal (3).

## Control lever at seat

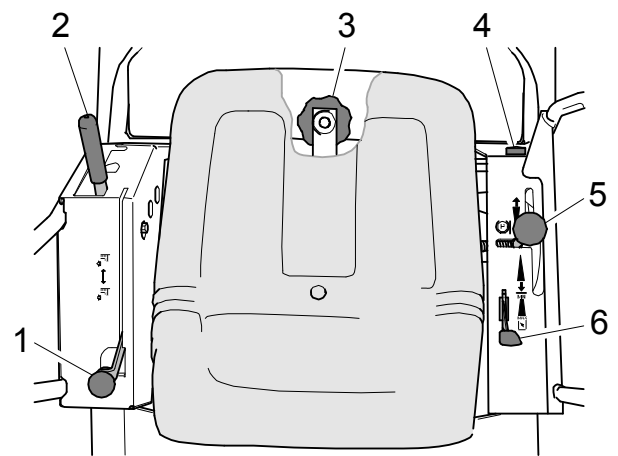

### Blade clutch lever (1)

The blade clutch lever is a protective device. When you declutch the blade, the blade comes to a standstill within 5 seconds.

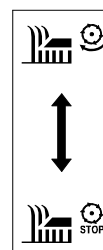

#### Declutching the blade:

Set the accelerator lever to MIN. Guide the blade clutch lever backwards.

#### Clutching the blade:

Slowly pull forward the lever.

## Cutting height adjustment (2)



The cutting height of the lawn can be set to four positions.

The top position is the transport position.

## Sitting position

Slacken the star grip (3) and move the seat to the desired position. Then tighten the star grip.

## Ignition lock (4)

The ignition lock has three positions.

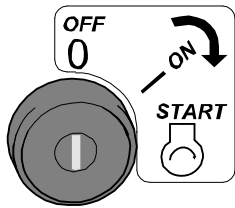

OFF: Ignition off.  
The key can be removed.

ON: Ignition on.

START: Electric starter on.

## Drive lever with parking brake (5)

The drive lever is needed to drive forward and in reverse as well as to stop the mower. The further you move the lever in one or the other direction, the faster the device moves.

In the neutral position, the parking brake is actuated.

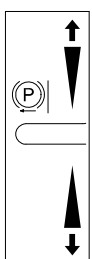

Moving forward

Stopping (neutral position/parking brake)

Moving in reverse

## Accelerator lever with choke (6)

Via the accelerator lever, you change the engine speed and control the engine performance. When you want to start the device when the engine is cold, move the accelerator lever to choke position (choke is closed).



MIN: Idling speed. Press the accelerator lever all the way forward.

MAX: Full throttle position.

Choke: Choke is closed (only for cold engine start). Pull the accelerator lever all the way back.

## Drive/idle mode



### Caution!

Engine startup with unlocked drive can destroy the hydraulic drive.

Never start the engine when the drive is unlocked.

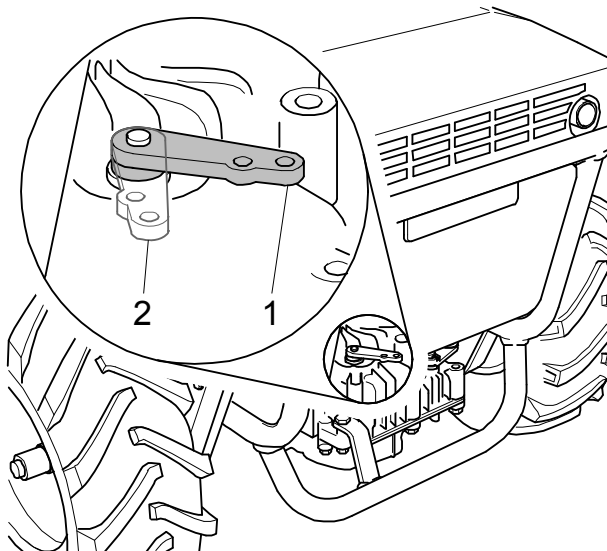

To push a mower without engine drive, unlock the drive at the rear of the device and release the parking brake. In this condition, the mower can only be braked with the parking brake.

1: Locked

2: Unlocked (idling)

## Transport

Transport the device on a freight vehicle or a trailer which is designed for a carrying capacity of at least as great as the empty weight of the device.

### Transport on pallets

For transport over short distances, use a fork lift or a lift truck.

For longer distances, load the device with a fork lift onto a freight vehicle or trailer.

The user must be authorised to operate a fork lift. When the machine is lifted, all persons must step away from the working area of the fork lift.

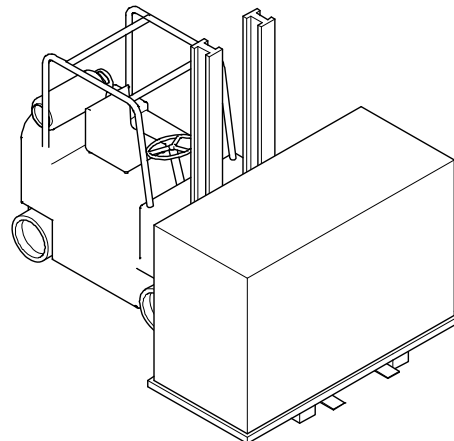

**Notice!** Drive the fork lift completely under the longitudinal beams of the wooden pallets.

### Transport of ready-to-use device



#### Warning!

Risk of injury due to the heavy weight of the device. The device can fall over and fall down and cause severe injuries.

Observe the following notices.

Prior to transport, let the device cool down for at least 20 minutes. Close the fuel valve.

#### Loading

Use suitable ramps for loading that

- can carry the empty weight of the device + 100 kg.
- are wider than the device.
- have a slip-free surface.

1. Put the device in front of the ramps and make sure that the ramps
  - are as wide as the wheel gauge of the device.
  - are tightly secured to the platform.
  - are not steeper than 15°.

- Carefully drive the device via the ramps onto the platform.
- Secure the device with belts to the frame elements that can hold the weight.
- Secure the device against rolling, sliding, tilting, and fuel and oil leakage.

### Unloading the device

- Undo the transport fastenings.
- Drive the device carefully down the ramps of the platform.

## Assembly

### Scope of delivery

The device is delivered in a carton on a pallet. The scope of delivery includes:

- The device.
- These operating instructions.
- Warranty card.
- Tool bag.
- Steering wheel with fitted key.
- Ignition key.
- Operating instructions of the engine manufacturer.

### Unpacking

- Remove the carton and the film.
- Check the air pressure of all tires (see Technical data).

## Mounting

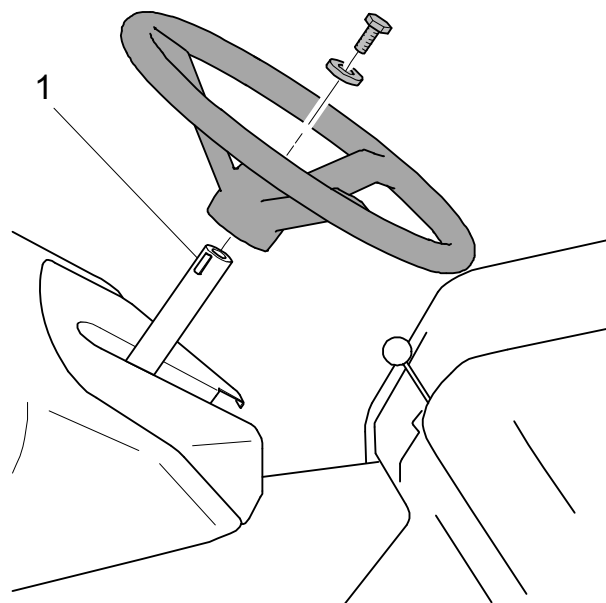

- Mount the steering wheel (observe the fitted key (1)).
- Remove both metal transport securing devices (one metal hook in the front and one metal hook in the rear is bolted to the pallet).
- Release the parking brake, unlock the drive and push the mower off the pallet.
- Relock the drive.

## Information on mowing

Prior to mowing, check your device for completeness, proper functioning, and cleanliness. A dirty ventilation grid can damage the engine and a dirty protective grid at the silencer poses a fire hazard.

Frequent engagement and disengagement of the clutch increases wear of the blade drive belt and the blade brake. Especially in case of high grass, clutch engagement leads to overload.

To keep the area well maintained, mow frequently and keep the grass short.

Only mow with a sharp and undamaged blade. Have the blade sharpened and balanced regularly (by authorised service centre).

Do not mow when the grass is wet or when it is raining. The turf may be damaged and there is a danger of slipping!

Turn the device around only in already mown sections.

Set the cutting height so that the blade does not touch the ground even in case of terrain unevenness.

Always set the blade to transport position when you do not mow.

For mowing, always turn the accelerator lever to full throttle to achieve the best mowing performance.

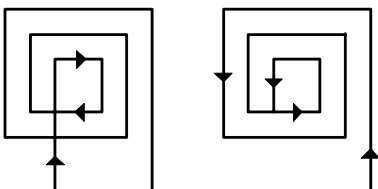

To avoid blockage during the ejection of grass, we recommend, for flat terrain, to proceed according to the mowing patterns. Mulch is shredded into much smaller pieces when you mow the terrain once again in the opposite direction.

## Prior to starting

### Checking the oil level

**Caution!** Before mowing, always check the engine oil level and the oil level in the hydrostat (see Maintenance).

### Fuel

As fuel, use unleaded petrol (see operating instructions of the engine manufacturer).

### Tanking up



#### **Danger!**

Fuel is ignited by hot engine parts. Prior to filling up, switch off the engine and wait for at least 20 minutes until the engine has cooled down. Observe the safety instructions regarding the fuel!

#### **Filling in the fuel:**

1. For filling, use a canister with a filler spout or use as funnel.
2. Open the canister carefully so that the existing overpressure is discharged slowly and no fuel spurts out.
3. Open the tank cap carefully so that the existing overpressure is discharged slowly and no fuel spurts out.
4. Fill the fuel tank.
5. Screw the tank cap on tightly.

### Adjusting the seating position

Adjust the seat in the longitudinal direction until your feet are positioned on the inclined support plates and you sit comfortably.

## Starting



### **Danger!**

During startup, there is a risk of injury caused by the rotating blade. Make sure that no one is within the danger zone of the blade.

## Safety switches

The device is equipped with safety switches. To start the engine, the following requirements must be met:

- A driver sits in the driver seat.
- The blade clutch is switched off.
- The lever for cutting height adjustment is in transport position.
- The drive lever is in neutral position.

If the engine is running and the driver leaves the seat, the engine is shut off.

If the engine was shut down due to a safety switch, turn the ignition key to position "Ignition off". By this, you will avoid discharging the battery.

## Starting the engine

Start the device only when it is positioned on even and firm terrain

1. Open the fuel valve.
2. Sit down on the driver seat.
3. Turn off the blade clutch.
4. Move the lever for the cutting height adjustment to transport position.
5. Move the drive lever to neutral position.
6. When the engine is cold:  
Move the accelerator lever to cold start position (choke).  
When the engine is warm:  
Move the accelerator lever to middle position.
7. Turn the ignition key to starting position.

8. Once the engine has started, release the ignition key.
9. Only for cold start:  
Move the accelerator lever to middle position.
10. For mowing, set the accelerator lever to the maximum speed.

If the engine does not start after 5 seconds, release the key. Wait for approx. 15 seconds before trying to start the device again.

## Engaging the blade

Only engage the blade when it turns freely and does not come into contact with objects or the floor.

Do not engage the blade in uncut grass because the blade drive otherwise becomes overloaded, can be damaged, or can wear prematurely.

1. Start the engine.
2. Move the lever for the cutting height adjustment to the highest cutting position.
3. Pull the blade clutch lever slowly forward - the blade starts up.
4. Set the desired cutting height.

If you set the cutting height to transport position during mowing, the blade is automatically disengaged.

## Disengaging the blade when running over paths:

1. Quickly pull the blade clutch lever rearwards.



## Driving



### **Danger!**

Mowing on a slope is dangerous. There is a risk of tilting and slipping. Observe the safety instruction for mowing on slopes.

In case of a hazardous situation, switch off the drive and declutch the blade.

## Braking



### **Warning!**

The brake does not work if you continue to hold the drive lever while braking. Release the drive lever when you actuate the foot brake.

To stop, move the drive lever slowly to neutral position.

The parking brake acts on the rear wheels. When the foot brake is actuated, the drive lever swivels all the way to neutral position/parking brake.

Use the actuation via foot pedal only in exceptional circumstances because the mower stops abruptly.

## Driving

1. Start the engine.
2. Release the parking brake.
3. Slowly move the drive lever to the desired driving direction. The further the lever is moved away from the neutral position, the faster the mower moves.
4. To stop, move the drive lever slowly to neutral position or step on the foot brake.

## Differential lock

The differential lock connects the two rear wheels rigidly to each other. This improves

traction. Actuate the differential lock when a wheel slips.

Always actuate the differential lock when moving downhill. This improves the driving stability of the device. The risk of sliding or swerving of the rear is reduced and safe braking is possible.

Driving in curves while the differential lock is actuated is only possible with limitations.

To avoid excessive wear:

- actuate the differential lock only when the device is stopped, if possible.
- always step on the pedal all the way.
- release the differential lock when it is no longer absolutely needed.

## Switching off and parking

1. Move the drive lever slowly to neutral position.
2. Turn the accelerator lever to idle speed.
3. Switch off the blade clutch.
4. Move the lever for the cutting height adjustment to transport position.
5. Actuate the parking brake.
6. Turn the ignition key to “ignition off”.
7. Wait until the blade comes to a standstill before you step away from the device.



### **Warning!**

Risk of injury in case of unauthorised use. Always remove the ignition key when you do not use the device.

8. Remove the ignition key.
9. Close the fuel valve.

## Maintenance and cleaning

Regular maintenance keeps your device ready for use.

If you do not observe the maintenance notices, faults may occur that are not covered

by the warranty. Operational safety is endangered as well.

Contact your authorised service centre for checkup if you detect problems during maintenance.

Component	Action	Maintenance interval	
		Before and after each use	Annually or every 50 h
Device	Check for safe working condition.	■	▲
	Clean.	■	
	Customer service.		▲
Fuel	Check fuel level.	■	
	Is the tank cap closed?	■	
Tank, fuel valve, and fuel line	Check parts for leaks and check for good condition.	■	▲
Ventilation grid	Clean.	■	▲
Engine cooling	Clean.		▲
Spark plug	Check/adjust.	■	
	Replace.		■▲
Air filter	Check/clean.	■	▲
	Replace.		■▲
Blade and fastening components	Check for wear and damage. See chapter Checking the blade.	■	▲
	Change.		▲
Blade brake	Does the brake function properly and does the blade come to a standstill within 5 seconds?	□	▲
Drive lever	Does the device stop when the lever is in neutral position (parking brake)?	□	▲
	Does the lever move to neutral position when the foot brake is actuated?	□	▲
V-belt	Are the V-belts tensioned correctly, without fissures, and in good condition?		▲

Component	Action	Maintenance interval	
		Before and after each use	Annually or every 50 h
Bowden cables	Check for proper function and ease of movement.	■	▲
Acceleration lever	Check for proper function.	□	▲
Chassis and impact protection	Check for rust and fissures and check the welding seams.	■	▲
	Are all protective device fastened correctly and properly functioning?	■	▲
Label	Condition of the labels.	■	▲
Engine	See operating instructions of the engine manufacturer.	■	▲
	Check oil level (see operating instructions of the engine).	■	▲
	Oil change.		▲
	Oil filter change.		▲
Parking brake	Check the parking brake.	■	▲
Foot brake	Check the foot brake.	□	▲
Flammable material	Remove easily flammable debris buildup from the engine and the device.	■	▲
Steering	Check the clearance.	■	▲
Tires	Check tires and tire pressure if necessary.	■	▲
Safety switches	Check the switches at the driver seat, cutting height adjustment, and drive for proper function.	■	▲
Ignition lock	Check for proper function.	□	▲
Hydrostat transmission	Check oil level.	■	▲
	Eliminate leak points, if necessary.		▲
	Oil change after 50 h and every 200 h thereafter.		▲
Battery	Check the charging condition.		▲
Lubrication	See chapter Grease lubrication.	■	▲ ■

- By the user when the engine is not running.
- By the user when the engine is running.
- ▲ By the authorised service centre.

## Preparations

---

### Prior to all maintenance and cleaning work:

1. Let the device cool down for at least 20 minutes.
2. Close the fuel valve and the tank ventilation.
3. Disconnect the minus pole of the battery.

**Caution!** During repair and maintenance work, lift the device only by the frame.

## Cleaning the device

---

After each use, you should clean the device thoroughly, especially the bottom side and the blade.

Stuck grass or dirt affect the grass discharge and the cutting quality. For a sufficient engine cooling, keep the engine cover, ventilation grid, and the engine clean.

For sufficient cooling of the hydrostat transmission, keep the gearbox casing and the area around the gearbox fan clean.

**Fire hazard!** Pay special attention so that components at the silencer are clean.

For cleaning use a hand brush. Remove stubborn soiling with a wooden or plastic spatula. Clean the outer housing parts with a cloth.

Do not rinse off the device with a water jet or high pressure cleaner! Do not use aggressive cleaning agents.

## General inspection

---

To ensure a safe working condition of the device, check all nuts, bolts, screws, connections of fuel lines, air filters, etc. regularly for firm seating. Check the ignition wire and the spark plug connector for damage.

Immediately replace any damaged or worn parts, especially in regards to covers, silencers, or fuel tank (authorised service centre).

Check the safety switches for proper function. The engine must not be started when:

- There is no driver in the driver seat.
- The blade clutch is switched on.
- The lever for the cutting height adjustment is not in transport position.
- The drive lever is not in neutral position.

If the engine is running and the driver leaves the seat, the engine must shut down.

Contact an authorised service centre if one of these conditions is not met.

## Checking the parking brake

---



### Danger!

If the parking brake is incorrectly adjusted, the device can roll away. Make sure that the parking brake is always functioning properly.

1. Put the device on a non-slip surface (e.g. concrete or asphalt).
2. Unlock the drive.
3. Actuate the parking brake.
4. Try to move the device.

If the rear wheels lock, the parking brake is correctly adjusted. If you can move the device, the parking brake must be re-adjusted by an authorised service centre.

## Checking the foot brake

---

Check if the drive lever returns to neutral position (parking brake) when the brake pedal is actuated.

## Grease lubrication

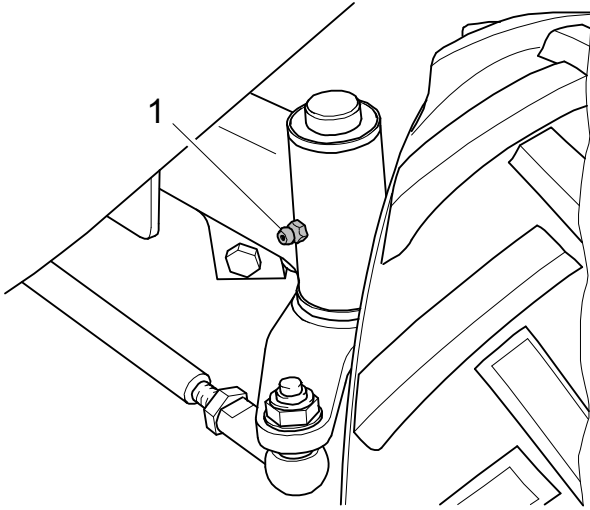

At each front wheel stub axle, a grease nipple is provided.

1. Clean the grease nipples.
2. Lubricate the grease nipples with a hand grease gun (1-2 strokes).
3. Remove any excess grease that has squeezed out from the bearing points.

## Chain lubrication

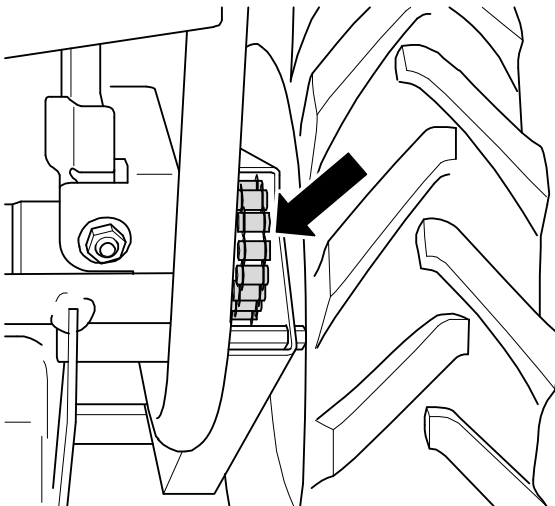

The chains on the right and left of the differential lock must be lubricated on a regular basis. We recommend the use of biodegradable chain spray.

## Checking the blade



### Danger!

Improperly mounted and maintained blades pose a severe injury hazard.

Work at the blade shall only be performed by an authorised service centre.

Work on the blade requires special qualifications because an unbalance test is required and the torques must be observed.

Before and after each mowing operation and in case of significant changes, check for wear, damages, and cracks.

Vibrations indicate that the blade or the mulching blade is worn excessively or on one side only.

Improperly sharpened blades or mulching blades increase the device load and result in fatigue cracks and breakage!

Ejected pieces can cause severe injuries.

### Blade change

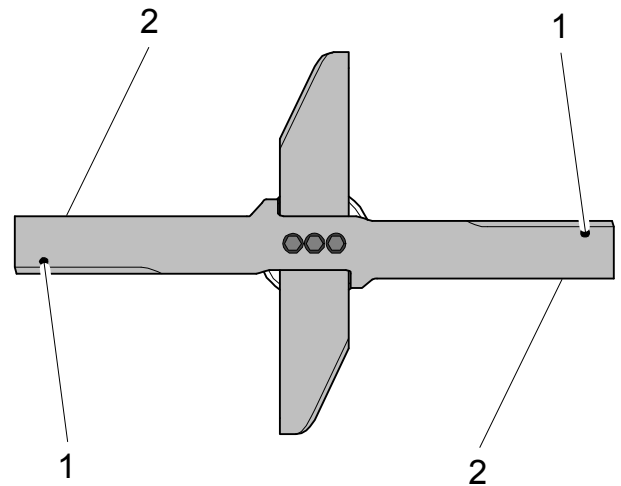

It is absolutely necessary to change the blade

- when one of the wear markings was reached. Original blades are engraved with wear markings (marking in form of a ball-shaped imprint on the blade bottom).
- When the thickness of the blade at the rear edge of the vane (2) or at another

point is below 1 mm (exception: cutting edge).

- At the least once per year or every 50 operating hours, whether there is wear or not. The material deteriorates, may show cracks and this can endanger persons and material goods.

An original AS blade can be recognised by these imprints:



XXXX corresponds to the spare part number.

### Checking the blade clutch

Check the blade clutch for proper function by declutching the blade. The blade must come to a standstill from full speed within less than 5 seconds. Contact an authorised service centre if this is not the case.

## Maintaining the engine



### Danger!

If the speed of rotation is set too high, objects can be ejected. The engine can be damaged and noise pollution increases.

Do not change the basic setting of the carburetor or the speed control.

The operating instructions of the engine are prepared by the engine manufacturer. They contain the maintenance instructions and the warranty conditions for the engine. If warranty work for the engine is required, please contact your authorised service centre or the nearest authorised engine dealer.

## Checking the engine oil level

The oil level must remain between the two markings of the oil dipstick. Make sure that the oil level is never below the bottom marking; otherwise the engine can be damaged. Never fill in oil above the top marking. Otherwise, there is a risk that the oil enters and destroys the air filter.

For this, observe the attached operating instructions of the engine.

## Checking the spark plugs



### Danger!

The ignition system generates an electromagnetic field.

Wearers of pacemakers must not work on live parts.

Soiled spark plugs reduce the engine output. Clean the electrode of the spark plug with a brass wire brush. Check the electrode gap (see operating instructions of the engine manufacturer). Make sure that the insulator around the electrode is not damaged. Never use a damaged spark plug.

Tighten the spark plug using the correct torque (see operating instructions of the engine manufacturer).

## Cleaning the air filter



### Danger!

Cleaning agents pose a fire and explosion hazard.

Never clean the air filter with flammable solvents.

Always make sure that the air filter is clean. A dirty air filter affects the engine output and increases the fuel consumption. Independent from the number of operating hours the filter inserts should be changed at least annually. Do not operate the engine without air filter.

For this, observe the attached operating instructions of the engine.

## Checking and charging the battery

---



### **Danger!**

When the battery is being charged, explosive gases escape.

Never charge the battery close to flames. Avoid sparking and do not smoke.



### **Caution!**

When the battery is connected, there is a risk of short circuit.

Do not put tools or metal objects onto the battery. Observe the assembly order when connecting and disconnecting the battery.

If the starter does not turn the engine or turns it too weakly charge the battery.

The battery is a maintenance-free and gas-tight dry battery. For charging the battery, you require a special charging system. Battery chargers for car batteries are not suitable!

**The charging current must not exceed the maximum of 3 ampere, otherwise, the battery heats up too much!**

Use electronically controlled charging systems. These charging systems detect the connected battery and charge it with the required charging current and terminate the charging process when the battery is full.

Charge the battery before you put the device away for winter storage. A fully charged battery lasts for approx. 4 months before it needs to be recharged.

**Caution!** Never confuse the plus and minus terminals.

1. Pull the tank out off the holders and put it to the right.
2. Disconnect the black cable (-).
3. Disconnect the red cable (+).
4. Dismantle the battery from the device.
5. Charge the battery.

6. Mount the battery into the device.
7. Connect the red cable (+).
8. Connect the black cable (-).
9. Remount the tank.

## Hydrostat transmission

---

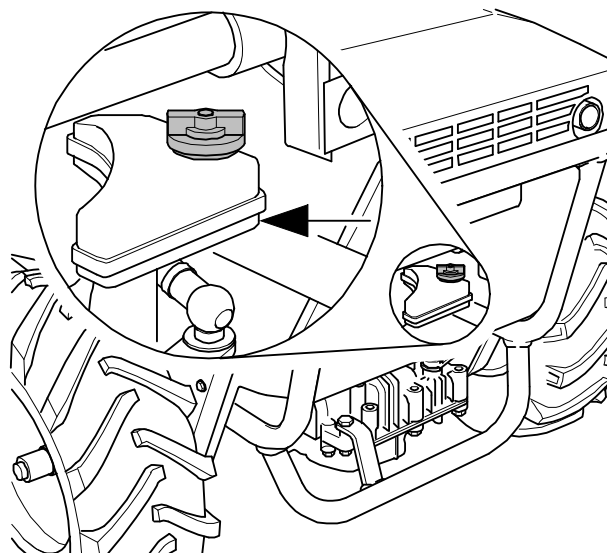

At operating temperature conditions, there must be no oil in the oil surge tank. In cold condition, the oil surge tank is empty.

The oil change must be carried out by an authorised service centre (see also maintenance chart). A between check of the oil level is not required.

Make sure that the gearbox fan is undamaged.

## Storage

### Storing the device

---

Keep the device in a closed, dry, and well ventilated room and out of reach of children. Always eliminate all problems of the device before you store it so that the device is always in a safe-to-operate state. Let the engine cool down before you store the device in closed rooms.

## Longer storage

---

1. Observe the safety instructions regarding the handling of fuel.
2. Draining fuel tank: Put a piece of a tube on the fuel valve and fill the fuel in an adequate fuel container.
3. Emptying carburetor: Start the engine and let it run until it stops on its own.
4. Clean the device thoroughly.
5. Touch up defects in painting (for spray paint, see Accessories).
6. Preserve the engine:
  - Unscrew the spark plug.
  - Fill a tablespoon of engine oil into the spark plug opening.
  - Briefly actuate the starter (oil is distributed in the cylinder).
  - Screw the spark plug back in.
  - Do not put the spark plug connector on!
7. Remove the ignition key and keep it separate from the device.

In autumn, have your device checked by an authorised service centre!

Also observe the notices on storage in the attached operating instructions by the engine manufacturer.

## Restarting

---

If you want to start the device after a longer storage, carry out the tasks described in chapter Maintenance.

## Spare parts

The reliable and safe operation of the device also depends on the quality of the spare parts used. Only use original spare parts and accessories that were approved by "AS-Motor Germany". When foreign parts are installed, the warranty and guarantee shall be void for the foreign part and for the device and for any resulting damage.

Inform your authorised service centre about the device type and serial number of your devices when you order spare parts.

## Wear parts

Some parts are wear parts. They wear during use and must be replaced. The warranty does not cover the following parts:

Blades, cutting blades, cutter bars, blade bolts, sliding plates, V-belt, chains, Bowden cables, starter ropes, pressure plates, air filters, spark plugs, disc springs, lock washers, fuses, discs, thrust plates, pressure discs, protection skirts, impact protection, wheels, tires.

## Accessories

Available accessories:

Trailer: E09311

Trailer hitch: E09312

Snow blade: E09314

Snow chains with conversion kit: E09317 (set)

Front lawn tires: E09318 (set)

Rear lawn tires: E09321 (set)

Spray paint 400 ml, colour orange: E04606

Operating hour counter: E10740

Clinometer E11835



## Disposal

The device cuts and shreds the plant material in a single operation. Shredded plant material decomposes quickly, can be utilized as fertilizer, and, therefore, be left on the ground.

Dispose of waste oil and fuel in accordance with the local regulations or return it to an oil shop.

Packaging, device, and accessories are made of recyclable materials and must be disposed off accordingly.

## Warranty

The conditions of the warranty can be found on the reverse side of your warranty card.

Send the filled-out warranty card immediately after the purchase of your device to "AS-Motor Germany" or the supplier. Otherwise, the warranty is no longer valid.

Preserve the proof of purchase or the warranty card that was filled out by the vendor.

## Troubleshooting

The following table contains the most frequent problems and their elimination. If more problems occur, contact the closest authorised service centre.

You can find an authorised service centre on our home page [www.as-motor.de](http://www.as-motor.de).

Problem	Possible cause	Remedy
<b>Starter does not turn</b>	Safety switches are not actuated.	<ul style="list-style-type: none"><li>– Drive lever to neutral position.</li><li>– Cutting height adjustment to transport position.</li><li>– Put driver in seat to activate seat contact switches.</li></ul>
	Battery is empty: <ul style="list-style-type: none"><li>– Ignition key was not in position "Off".</li><li>– Standstill period was too long.</li></ul>	Charge the battery (see Checking the battery) or have authorised service centre do so.
	Fuse is defective.	Replace (if necessary, have authorised service centre do so).
	Battery is defective.	Replace the battery (authorised service centre).
<b>Engine does not start</b>	Fuel valve is closed.	Open the fuel valve.
	No fuel in the tank.	Refill fuel.
	Choke is open.	Close the choke.
	Device was tilted - oil leaked into the air filter.	Replace air filter, unscrew the spark plug, and start several times while fuel valve is closed, dry spark plug

Problem	Possible cause	Remedy
		and screw it back in.
	Engine was flooded due to too many start attempts.	Unscrew the spark plug and start several times when fuel valve is closed, dry the spark plug and screw it back in.
	Spark plug connector is pulled off.	Observe the safety instructions! Put spark plug connector back on.
	Air filter is soiled.	Clean air filter (see also Maintenance and cleaning).
	Spark plug is sooted, damaged or incorrect electrode gap.	Clean the spark plug and check electrode gap (see also Maintenance and cleaning). If necessary, replace the spark plug.
	Housing of the mower is jammed.	See also Maintenance and cleaning.
	Fuel is poor quality, dirty, or old.	Clean the fuel system (authorised service centre). Always use fresh fuel.
<b>Engine starts badly or runs irregularly</b>	Choke is closed.	Open the choke.
	Air filter is soiled.	Clean air filter (see also Maintenance and cleaning).
	Fuel is of poor quality, dirty, or old.	Always use fresh fuel.
	Spark plugs are sooted, damaged or incorrect electrode gap.	Clean spark plugs and check electrode gap (see also Maintenance and cleaning). If necessary, replace spark plugs.
<b>Device does not move</b>	Drive is unlocked.	Lock the drive.
	Hydrostat drive is overheated.	Cool it down (see also Maintenance and cleaning).
<b>Blade cannot be engaged</b>	Lever for cutting height adjustment and transport position.	Lower lever for cutting height adjustment to the desired cutting height.
<b>The blade does not rotate</b>	V-belt is insufficiently tensioned or damaged.	Authorised service centre.
	Bowden cable is defective.	Authorised service centre.

Problem	Possible cause	Remedy
<b>Strong vibrations during operation</b>	Unbalance at the blade caused by incorrect sharpening or chips on the blade.	Have blade balanced and re-sharpened by an authorised service centre. Replace a damaged blade immediately.
	Blade drive shaft is bent by collisions with foreign objects.	Authorised service centre.
	Engine fastening is loose.	Authorised service centre.
	Blade fastening is loose.	Authorised service centre.
<b>Irregular noises</b>	Loose fastening elements.	Authorised service centre.
	Silencer defective.	Authorised service centre.
<b>Engine is smoking</b>	Air filter is soiled or drenched with oil.	Clean or replace the air filter (see also Maintenance and cleaning).
	Oil level is too high.	Have authorised service centre lower the oil level to the marking.
<b>Engine gets hot</b>	Ventilation grid is dirty.	Clean ventilation grid.
	Oil level in the engine is too low.	Refill engine oil (see operating instructions of the engine manufacturer).
	Cooling fins of the engine are dirty.	Have cooling fins cleaned by authorised service centre.
<b>Uneven cut, lawn becomes unsightly</b>	Blade is dull or worn.	Have blade resharpened and balanced by an authorised service centre. Have a damaged blade immediately replaced.
	Speed is too high proportionately to the cutting height.	Reduce speed and/or select the correct cutting height.
	Housing of mower is heavily soiled.	Clean.
	Different tire pressures.	Check the tire pressures.
	Mower housing is not parallel to the ground.	Adjust (authorised service centre).
<b>Mulching result with high plant material not satisfactory</b>	Speed is too high.	Reduce speed.

Problem	Possible cause	Remedy
<b>Mulching result with low plant material not satisfactory</b>	Plant material is ejected too quickly.	Increase speed.
<b>Housing is jammed</b>	Mowed grass was too long or too damp.	Adjust cutting height and mowing speed to the mowing conditions.
	Blade is worn.	Authorised service centre.
	Engine speed too low despite full power.	Authorised service centre.
<b>The device does not stop when brake is actuated</b>	Brake is adjusted incorrectly, worn, or defective.	Authorised service centre.
<b>The engine does not switch off</b>	Switching off system is defective.	Close the fuel valve. Authorised service centre.
<b>The tires become flat</b>	Thorns or other sharp objects damage the tires.	If necessary, use tire protection gel (authorised service centre).

## Technical data

<b>Type</b>	AS 800 FreeRider
<b>Range of application (temperature)</b>	5 – 30 °C
<b>Engine, type</b> Manufacturer Type Cylinder capacity Performance Engine speed	One cylinder four stroke engine Briggs & Stratton Intek 13.5 OHV engine 344 cm <sup>3</sup> 7.6 kW (10.3 PS) 3200 min <sup>-1</sup> See also operating instructions of the engine manufacturer.
<b>Starting device</b>	Electric start
<b>Battery</b>	12 V, approx. 19 Ah
<b>Fuses</b> General maxi fuse Fuse regulator generator	15 A 20 A
<b>Drive</b> Speed forward Speed reverse	Hydrostat transmission with differential lock 0 up to 8 km/h 0 up to 6.0 km/h
<b>Maximum area coverage</b>	approx. 6800 m <sup>2</sup> /h
<b>Turning radius</b>	approx. 1.2 m
<b>Front axle</b>	Pendular axle
<b>Seat</b>	Movable, spring mounted
<b>Cutting device, type</b> Cutting width Cutting height Drive of cutting tool Clutch of cutting tool Growth height	Cutter bar and mulching blade 80 cm 35 to 85 mm in 4 levels V-belt Belt tension clutch Up to approx. 80 cm
<b>Measures and weights</b> Weight Transport size with packaging L/W/H Max. tire dimensions L/W/H Max. towing load Max. coupling load	227 kg 1860/1100/1040 mm 1700/870/960 mm 100 kg 25 kg

<b>Type</b>	AS 800 FreeRider
<b>Capacities</b> Fuel tank Engine oil Transmission oil (hydrostat)	15 litres (lead-free regular petrol) approx. 1.7 litres SAE 30 (see also Checking the oil level) 1.95 litres SAE 10W30 or 10W60 (Castrol)
<b>Sound level</b> Measured sound level $L_{WA}$ Guaranteed sound level $L_{WA}$ Sound level at working place $L_{pA}$	97 dB according to DIN EN 836 98 dB according to DIN EN 836 82 dB according to DIN EN 836
<b>Vibrations emission value</b> Hand-arm-vibrations $a_{h,w}$ Measurement uncertainty U Whole body vibration $a_{h,w}$ Measurement uncertainty U	1,7 m/s <sup>2</sup> according to DIN EN 836 1,5 m/s <sup>2</sup> 0.6 m/s <sup>2</sup> according to DIN EN 836 0.5 m/s <sup>2</sup>
<b>Tire pressure</b> Front Rear	1 bar 1.5 bar



AS-Motor Germany GmbH & Co. KG  
Ellwanger Straße 15  
D-74424 Bühlertann  
www.as-motor.de

## Declaration of conformity

We declare that the lawnmower type  
with serial number

AS 800 FreeRider  
starting from 016010020001

as brought into circulation by us conforms to all relevant  
safety and health requirements of the EC directives listed.

- 2006/42/EG, L76, 16.03.2007  
- 2000/14/EG, L165, 17.06.2006  
- 2004/108/EG, L390, 31.12.2004  
- 97/68/EG, L59, 27.02.1998

### Function:

The device is intended for cutting and mulching grass or  
similar vegetation in well maintained areas that must be  
mowed at least once a year.

Applied standards:

EN 836

Applied conformity assessment procedure:

Annex VI

Measured sound level:

97 dB (A)

Guaranteed sound level:

98 dB (A)

### Party involved:

TÜV Rheinland Product Safety GmbH, D-51105  
Köln, Am Grauen Stein

Person authorised to compile the relevant technical documentation:

Frank Einsiedler  
AS-Motor Germany GmbH & Co. KG  
Ellwanger Straße 15  
D-74424 Bühlertann

Bühlertann,  
July 2010

By proxy Frank Einsiedler  
Head of development

Christoph Weber  
Managing director



AS-MOTOR GERMANY GmbH & Co. KG  
Ellwanger Straße 15  
D-74424 Bühlertann  
[www.as-motor.de](http://www.as-motor.de)

## Professional technology for gardens and landscapes

Allmäher®	Manoeuvrable meadow mower for extensive green area care. The Allmäher reliably shreds high grass, scrub, and weeds also on steep slopes and in difficult terrain. The grass cuttings are left to fertilise the ground so there is no more raking grass.
Ride-on Allmäher®	Ease of use and high area coverage all combined in a compact lawn mower. Low centre of gravity, optimum weight distribution, and broad wheel base provide you with the best performance on slopes and power reserves for shredding high plant growth. Also available in an all-wheel version providing the extra traction for demanding applications and for superior safety on slopes.
Rear discharge mower	Professional lawn mower with rear discharge. With wheel drive and infinite speed regulation for exceptional cutting and catching performance in any situation.
Rotary mower	The economic alternative to bar mower. Ideal for fodder production. The grass is not shredded and placed into a pile on the side.
Flail mower	The flail mower blades are supported movably and avoid rocks and other obstacles and chop the cuttings several times. The steel housing is 3 mm thick and offers very high security against foreign objects that were ejected and blown around and catches them safely.
Side discharge mower	This solid allrounder has a side discharge, wheel drive, and a housing of 3 mm thick plastic-coated steel. Also available in an all-wheel drive version and infinite speed regulation (Variomatic).
WeedHex	Removes weeds carefully, quickly, and without the use of chemicals: on transport surfaces, walls, curbs, and between interlocking blocks. The patented pivoting brush system goes easy on surfaces and is environment-friendly regarding harmful herbicides.